

TiLite manual wheelchairs | Creative Mobility Division

Side guard options

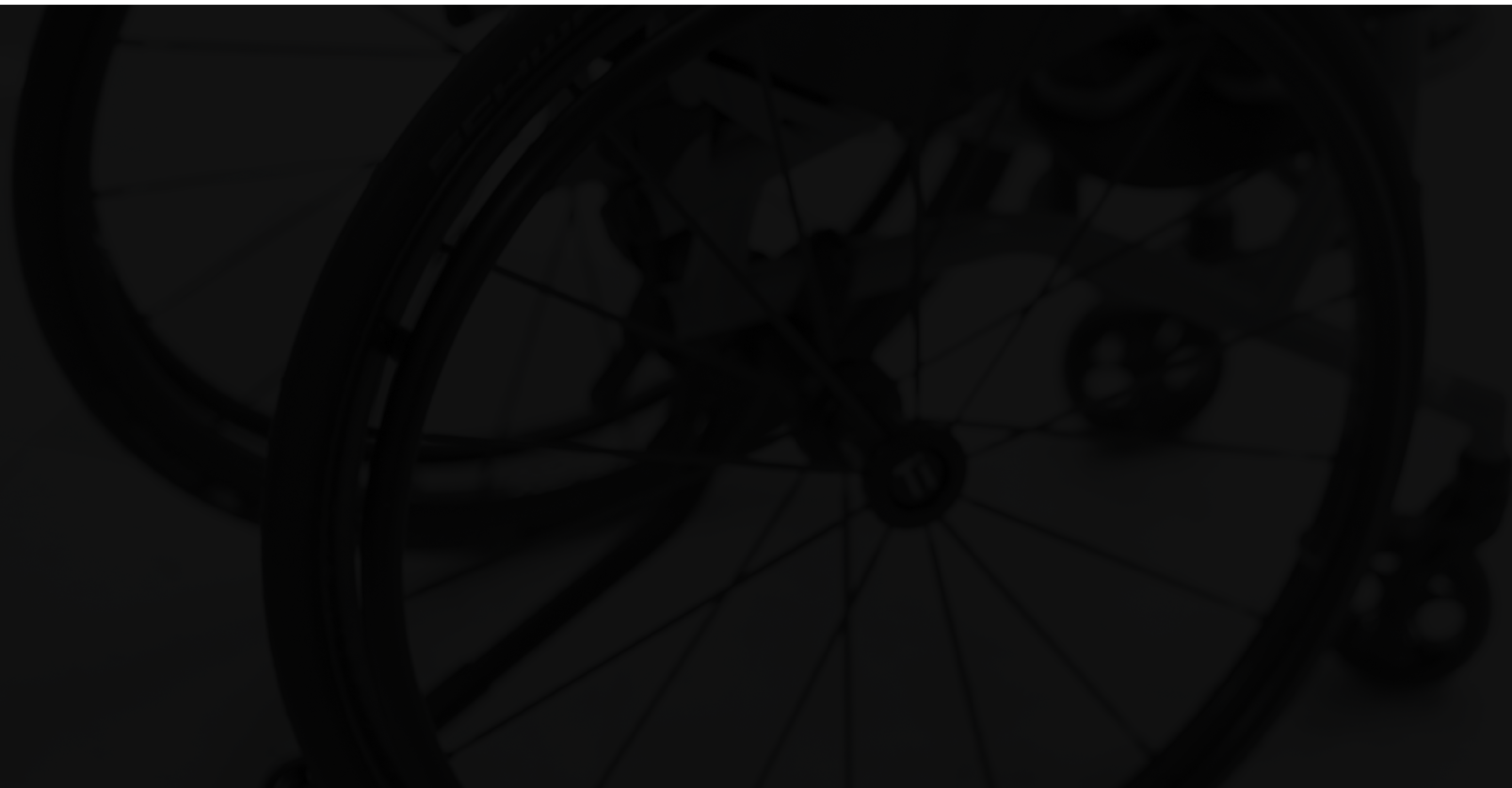

How to order

Catalog

1. Identify CMDs you wish to order and fill out. Please confirm compatibility with the chair you're ordering.
2. Fill out the catalog page corresponding to that CMD with the required information for us to complete your request.
 - EZ-Ti ID, PO#, or Quote# if available.
 - Measurements, selections, and special instructions if necessary.
3. Email the filled out page(s) to chairs.tilite@permobil.com and include Order Form if applicable.

Order Forms

1. Identify CMDs you wish to order and fill out. Please confirm compatibility with the chair you're ordering.
2. In the "Notes" section on the last page of the order form, include the following information:
 - CMD number(s) being requested.
 - Measurements, selections, and special instructions if necessary.
3. Submit Order Form via email (chairs.tilite@permobil.com) or fax (509) 586-2413.

EZ-Ti

1. Identify CMDs you wish to order and fill out. Please confirm compatibility with the chair you're ordering.
2. In the "CMD" section on the Summary page of EZ-Ti, include the following information:
 - CMD number(s) being requested.
 - Measurements, selections, and special instructions if necessary.
3. Submit quote request via EZ-Ti.

Please note, custom requests may impact quote turnaround time and chair build time. Pricing for these custom options may vary based on the amount of added labor and material costs.

Offset profiled side guard (removable or fold-down) CMD #7

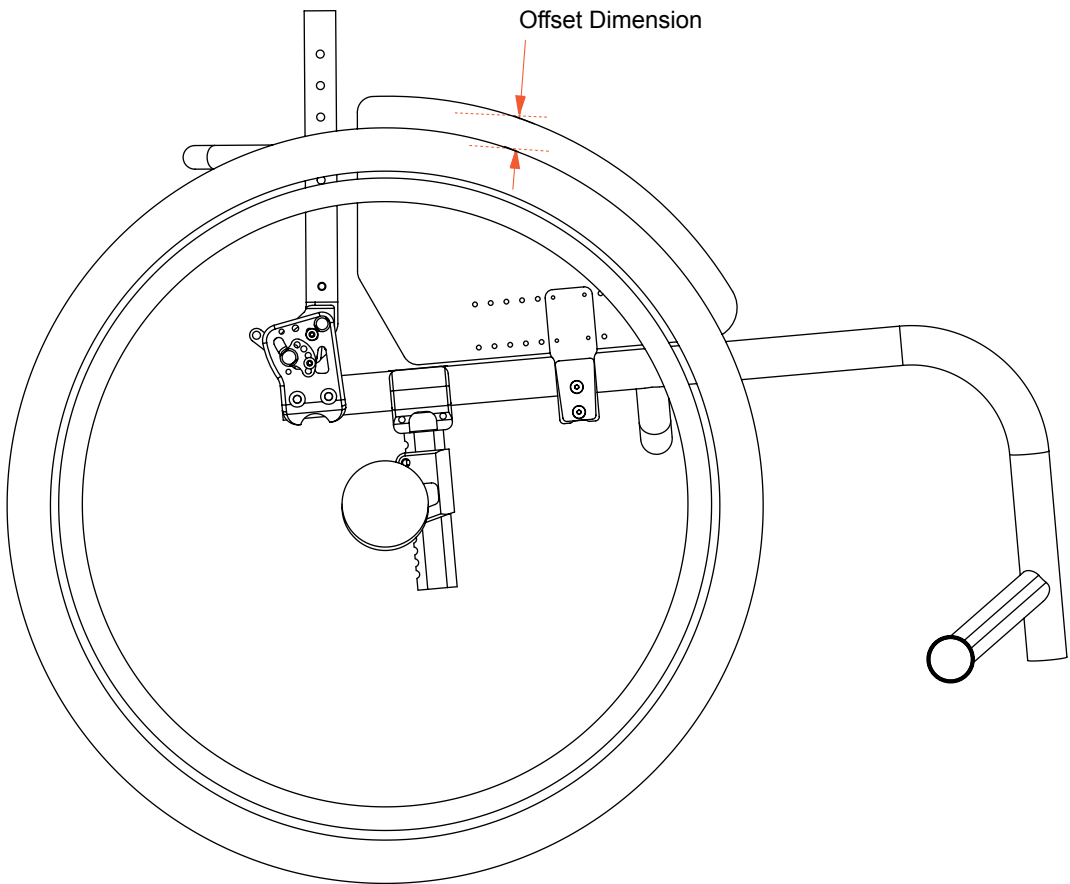

EZ-Ti ID _____

PO# _____

Clinical rationale

Modification intended to allow for specified offset (height) between edge of the side guard and edge of rear wheel, giving the customer the ability to increase the size of the side guard as needed for more protection or comfort.

Available on:

TiLite TR, TiLite TRA, TiLite Aero T, TiLite ZR, TiLite ZRA, TiLite Aero Z, TiLite TWIST, TiLite Aero X, TiLite 2GX

Notes:

- Requires rigid-removable or fold-down side guards.
- Aluminum or Carbon Fiber side guard must be selected.
- Side guard panel can be above or below the rear tire.
- Side guards will be cut profiling the rear tire if no offset is selected below.
- Aluminum side guards are black powder-coated with edge molding.
- May not work with all chair configurations.
- Folding wheelchair models are not compatible with fold-down side guards.

Required information

(Insert required information for CMD-E to complete this request)

Select one: ☐ Removable OR ☐ Fold-down

Offset: _____

Above or Below Tire Diameter: _____

Special Instructions



⚠ NOTE: Permobil's warranty does not cover Creative Mobility Division frames and frame components, unless Permobil determines that the frame or frame component was defectively manufactured.

Adapted spacing on desk arm CMD #12

EZ-Ti ID _____

PO# _____

Clinical rationale

Modification indicated to allow for proper fit of client in their wheelchair due to width constraints on the chair. Modification allows for wider seat width while maintaining overall chair width.

Available on:

TiLite TR, TiLite TRA, TiLite ZR, TiLite ZRA, TiLite Aero Z, TiLite Aero T, TiLite Aero X, TiLite 2GX, TiLite TWIST

Notes:

- This adaptation is not available with 2-point desk arm option.
- Non-standard desk arm spacing may require rear wheels spacing to be increased for clearance.
- Offsets are selectable in 1/4" increments up to 1".
- May not work with all chair configurations.

Required information

(Insert required information for CMD-E to complete this request)

Desk Arm Offset (1/4" increments only): _____

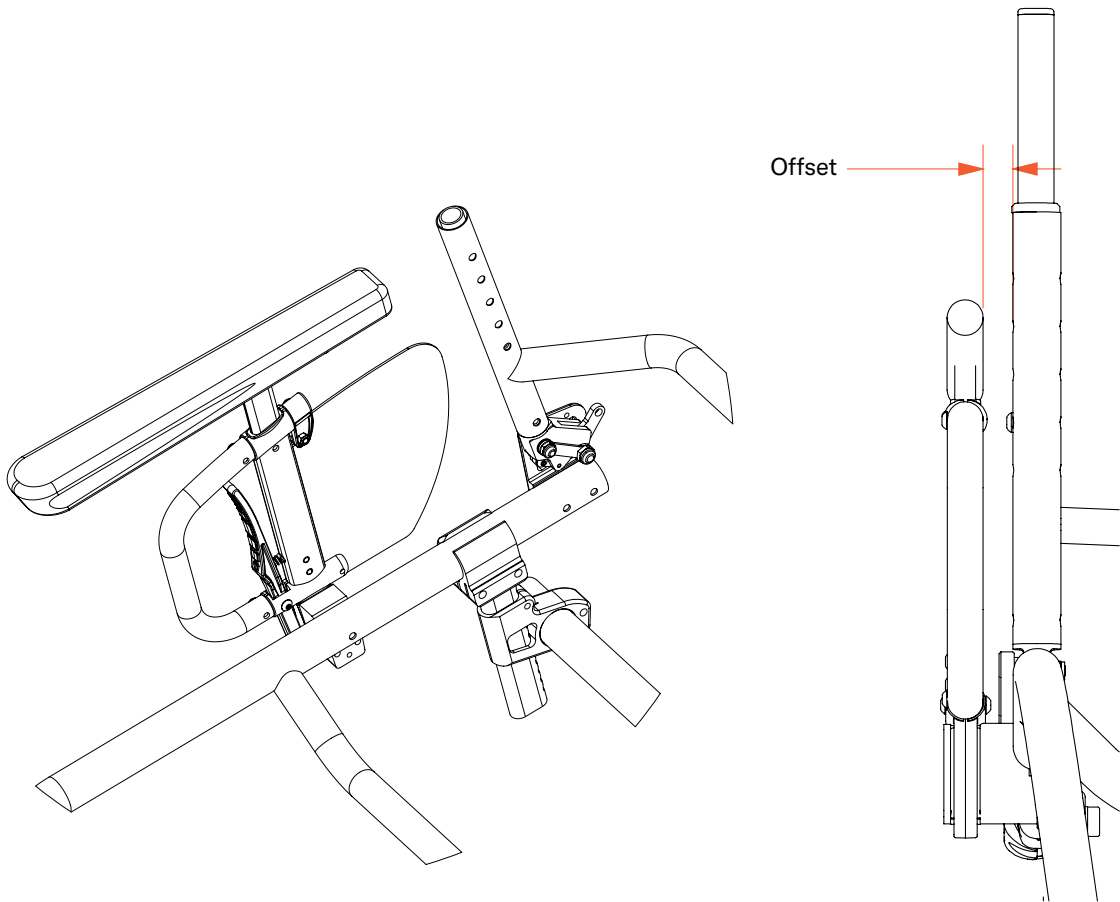

Special Instructions



⚠ NOTE: Permobil's warranty does not cover Creative Mobility Division frames and frame components, unless Permobil determines that the frame or frame component was defectively manufactured.

Adapted spacing on flat, rigid-removable side guard CMD #15

EZ-Ti ID _____

PO# _____

Clinical rationale

Modification is indicated for individuals who may require more width without getting a wider seat width measurement, or who may not be eligible for a new manual wheelchair.

Available on:

TiLite TR, TiLite TRA, TiLite ZR, TiLite ZRA, TiLite Aero T, TiLite Aero Z, TiLite Aero X, TiLite 2GX, TiLite TWIST

Notes:

- Non-standard side guard spacing may require rear wheels spacing to be increased for clearance.
- Offsets are selectable in 1/4" increments up to 1".
- May not work with all chair configurations.

Required information

(Insert required information for CMD-E to complete this request)

Side guard offset (1/4" increments only): _____

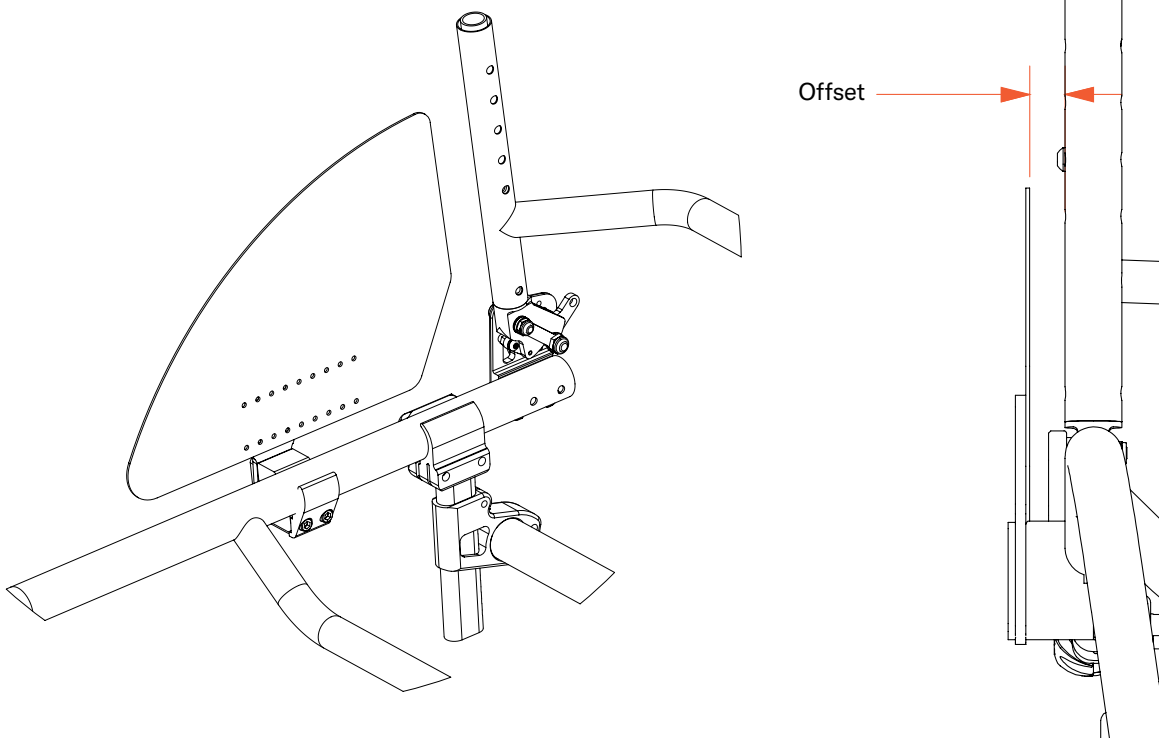

Special Instructions

permobil

⚠ NOTE: Permobil's warranty does not cover Creative Mobility Division frames and frame components, unless Permobil determines that the frame or frame component was defectively manufactured.

Carbon fiber fendered side guards fixed in place CMD #33

EZ-Ti ID _____

PO# _____

Clinical rationale

Modification is indicated for individuals who require fender side guard to protect clothes and they do not require it to be removed.

Available on:

TiLite TR, TiLite TRA, TiLite ZR, TiLite ZRA

Notes:

- May not work on all configurations.
- CMD-E to approve clearances and identify limitations.
- Must be on a titanium non-folding backrest.
- Carbon fiber fendered panels ONLY.
- Offset dimension must be no less than 1/4" above rear tire.

Required information

(Insert required information for CMD-E to complete this request)

Default offset will be set at 1/4" above rear tire if no offset dimension is denoted below

Requested Offset Dimension: _____

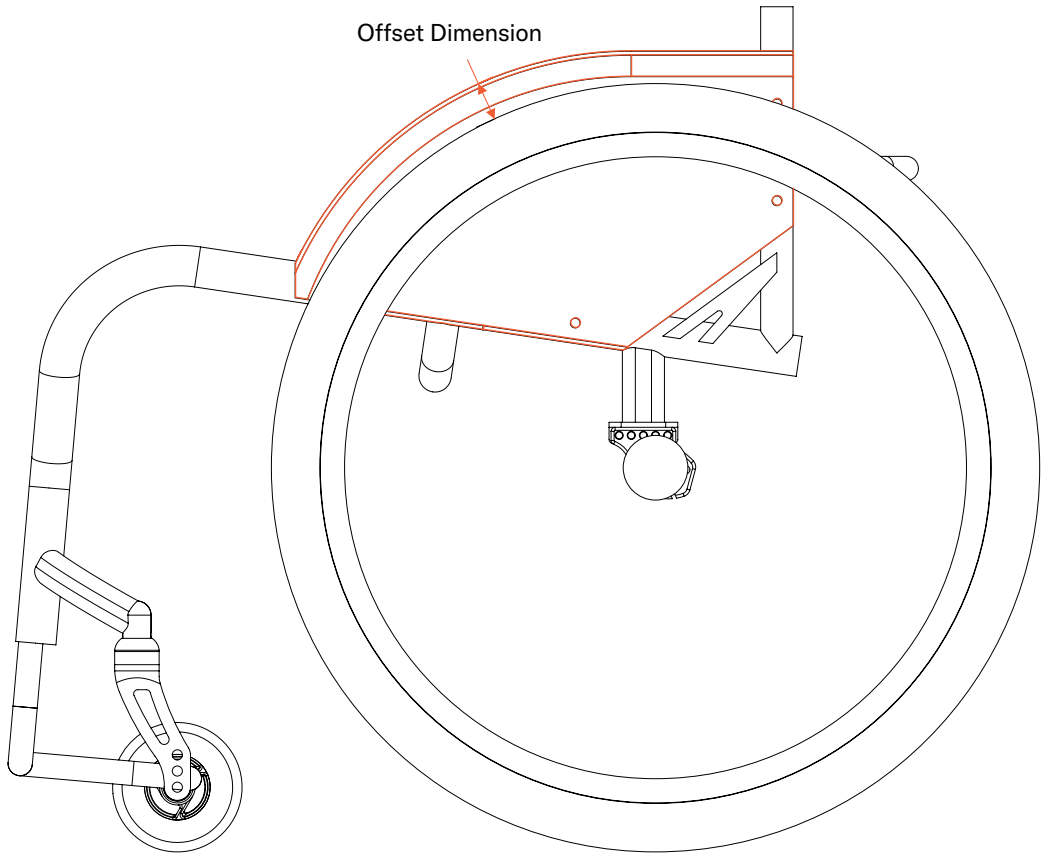

Special Instructions



⚠ NOTE: Permobil's warranty does not cover Creative Mobility Division frames and frame components, unless Permobil determines that the frame or frame component was defectively manufactured.

Titanium welded on calf strap loops

CMD #34

EZ-Ti ID _____

PO# _____

Clinical rationale

Modification is indicated for individuals who require precise placement of calf strap for lower extremity positioning and to prevent rearward migration of lower extremities on the footplate.

Available on:

TiLite TR, TiLite TRA, TiLite ZR, TiLite ZRA

Notes:

- May not work with all chair configurations.
- Only available on Titanium frames.

Required information

(Insert required information for CMD-E to complete this request)

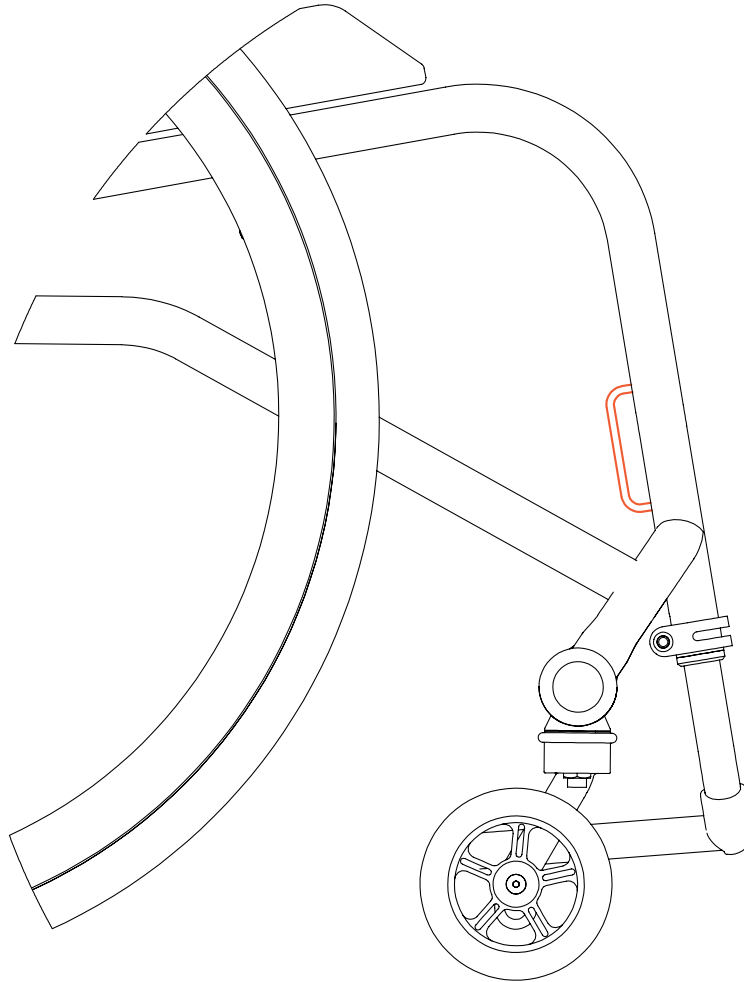

Special Instructions



⚠ NOTE: Permobil's warranty does not cover Creative Mobility Division frames and frame components, unless Permobil determines that the frame or frame component was defectively manufactured.

Polished stainless steel side guards

CMD #41

EZ-Ti ID _____

PO# _____

Clinical rationale

Modification indicated for individuals who require a side guard and also desire a side guard that does not remove and has durability.

Available on:

TiLite TR, TiLite TRA, TiLite ZR, TiLite ZRA, TiLite Aero T, TiLite Aero Z, TiLite 2GX, TiLite Aero X

Notes:

- The fixed side guard option is only available on Titanium RIGID wheelchairs with non-folding backrests.
- Side guard panel is profiled to rear wheel unless an offset (above or below the rear tire) is denoted below.
- Rigid-removable side guards are the only ones available on folding chairs (fixed and fold down are not available with folding model wheelchairs).
- May not work with all chair configurations.

Required information

(Insert required information for CMD-E to complete this request)

Offset Dimension: _____

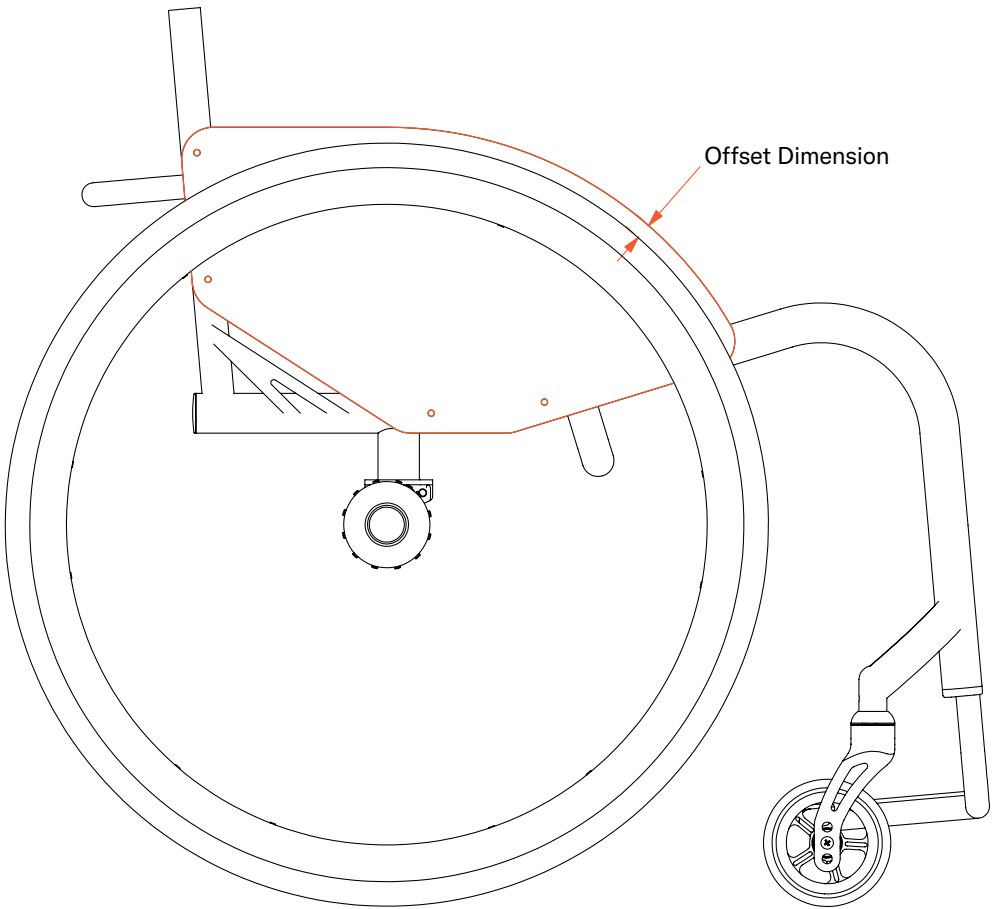

Special Instructions



⚠ NOTE: Permobil's warranty does not cover Creative Mobility Division frames and frame components, unless Permobil determines that the frame or frame component was defectively manufactured.

Folding chair clamp-on, non-removable side guards CMD #60

EZ-Ti ID _____

PO# _____

Clinical rationale

Modification indicated for individuals who require a side guard and desire a side guard that does not remove and is compatible with a folding frame.

Available on:

TiLite Aero X, TiLite 2GX

Notes:

- Aluminum or Carbon Fiber side guard must be indicated.
- Side guard panel can be above or below the rear tire.
- Side guards will be cut profiling the rear tire if no offset is selected below.
- Aluminum side guards are black powder coated with edge molding.
- May not work with all chair configurations.

Required information

(Insert required information for CMD-E to complete this request)

Offset: _____

Above or Below Tire Diameter: _____

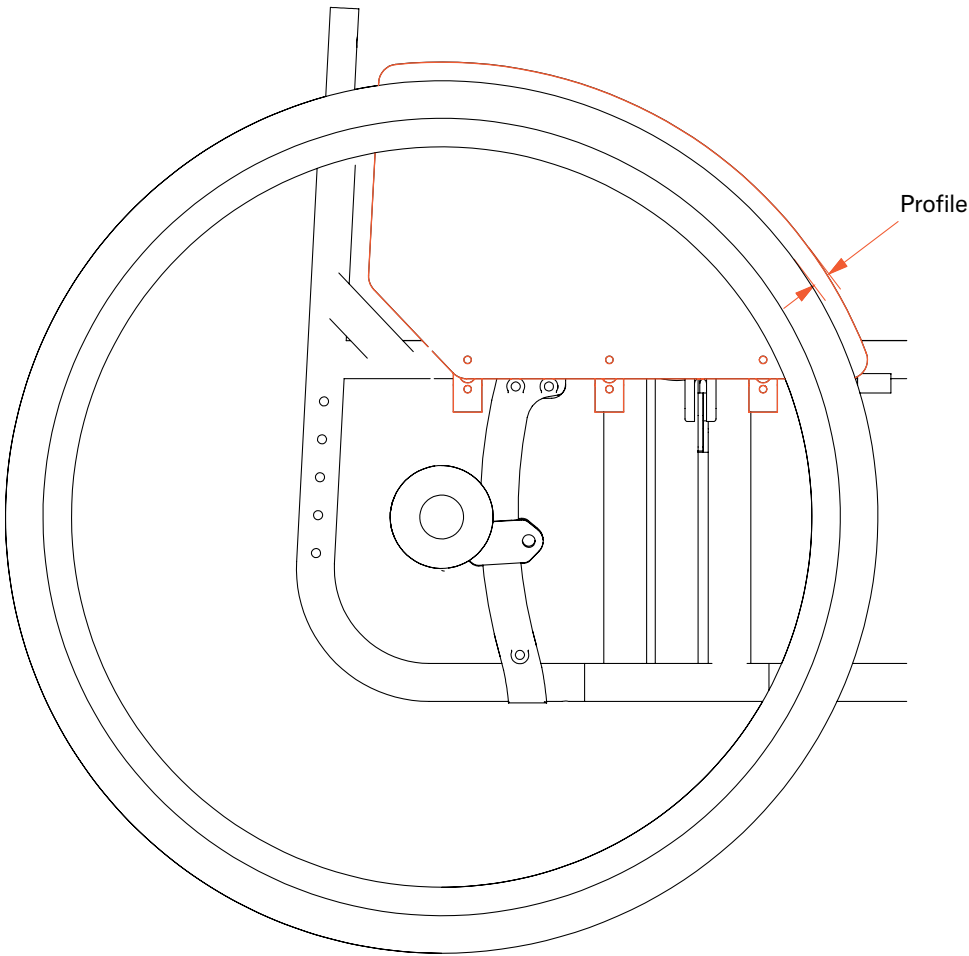

Special Instructions



⚠ NOTE: Permobil's warranty does not cover Creative Mobility Division frames and frame components, unless Permobil determines that the frame or frame component was defectively manufactured.

Flat fixed side guards

CMD #73

EZ-Ti ID _____

PO# _____

Clinical rationale

Modification indicated for individuals who require a side guard and desire a side guard that does not remove.

Available on:

TiLite TR, TiLite TRA, TiLite TX1, TiLite ZR, TiLite ZRA

Notes:

- Non-folding backrest required.
- May not work with all chair configurations.
- Side guard panel is profiled to rear wheel unless off-set dimension indicated below.
- Side guard panel can be Aluminum or Carbon Fiber.

Required information

(Insert required information for CMD-E to complete this request)

Offset Dimension: _____

☐ Aluminum OR ☐ Carbon fiber

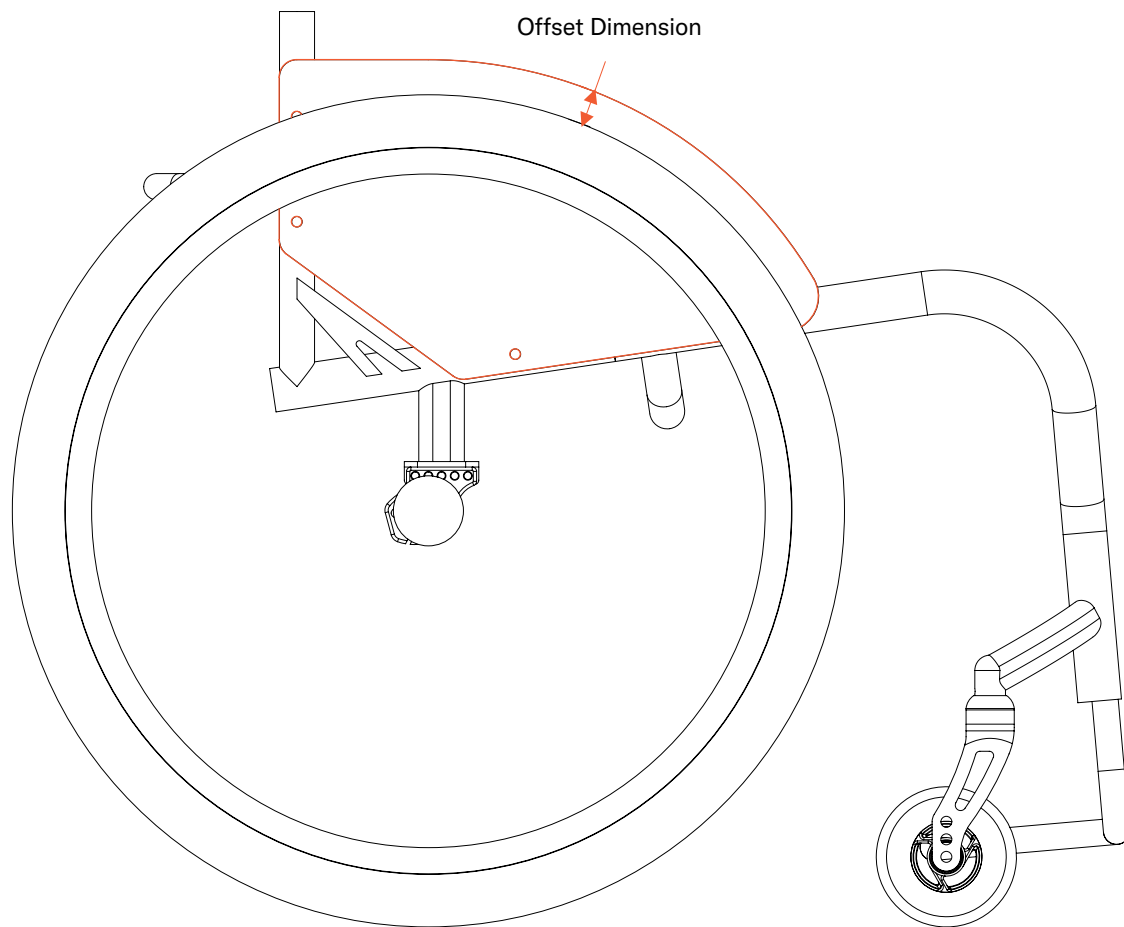

Special Instructions

permobil

⚠ NOTE: Permobil's warranty does not cover Creative Mobility Division frames and frame components, unless Permobil determines that the frame or frame component was defectively manufactured.

TiLite manual wheelchairs

Creative Mobility Division

2701 West Court St, Pasco, WA 99301
Phone +1 509 586 6117 | 800 545 2266



permobil