

TiLite manual wheelchairs | Creative Mobility Division

# Seat upholstery options

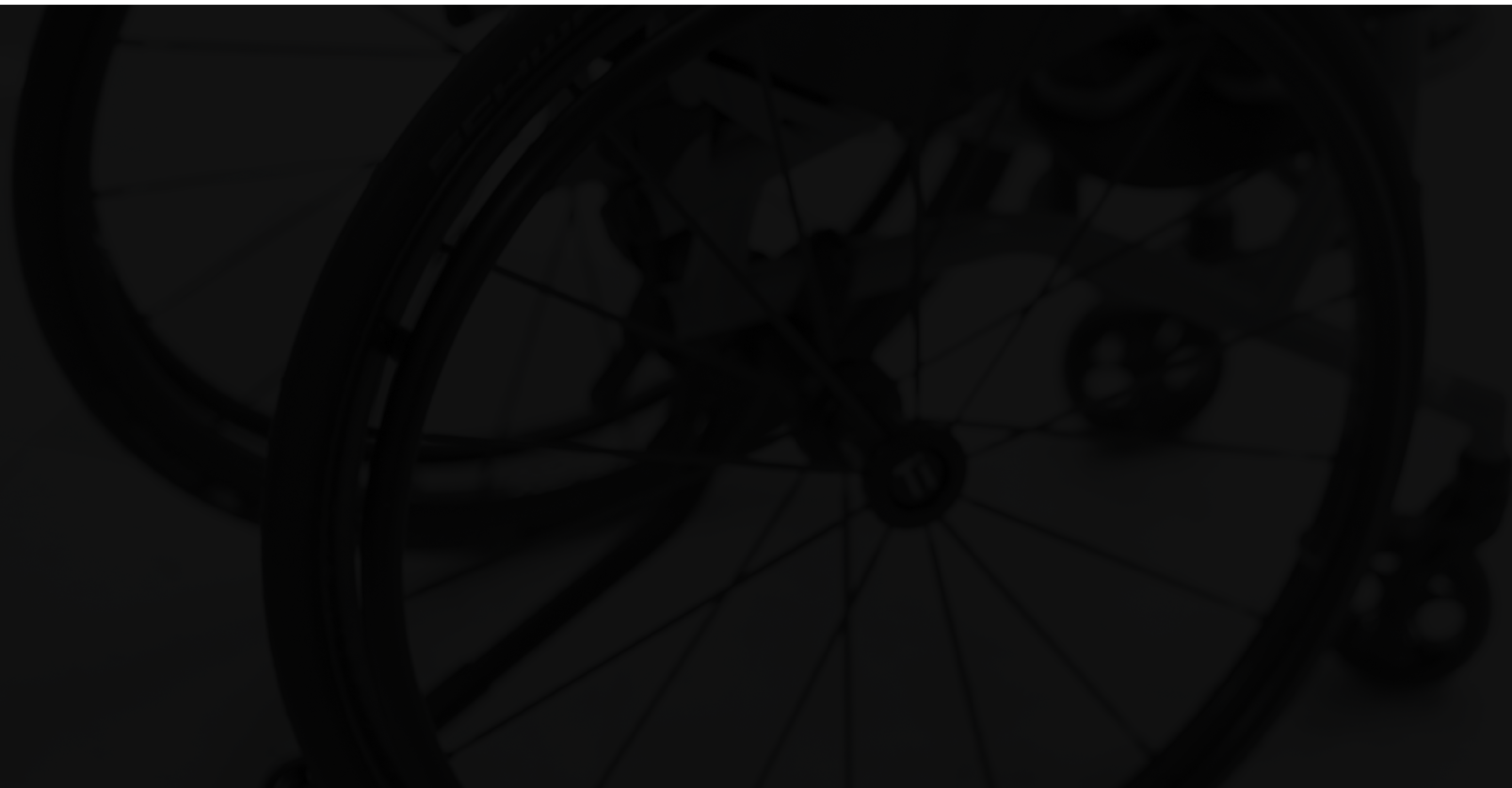

# How to order

## Catalog

1. Identify CMDs you wish to order and fill out. Please confirm compatibility with the chair you're ordering.
2. Fill out the catalog page corresponding to that CMD with the required information for us to complete your request.
  - EZ-Ti ID, PO#, or Quote# if available.
  - Measurements, selections, and special instructions if necessary.
3. Email the filled out page(s) to [chairs.tilite@permobil.com](mailto:chairs.tilite@permobil.com) and include Order Form if applicable.

## Order Forms

1. Identify CMDs you wish to order and fill out. Please confirm compatibility with the chair you're ordering.
2. In the "Notes" section on the last page of the order form, include the following information:
  - CMD number(s) being requested.
  - Measurements, selections, and special instructions if necessary.
3. Submit Order Form via email ([chairs.tilite@permobil.com](mailto:chairs.tilite@permobil.com)) or fax (509) 586-2413.

## EZ-Ti

1. Identify CMDs you wish to order and fill out. Please confirm compatibility with the chair you're ordering.
2. In the "CMD" section on the Summary page of EZ-Ti, include the following information:
  - CMD number(s) being requested.
  - Measurements, selections, and special instructions if necessary.
3. Submit quote request via EZ-Ti.

Please note, custom requests may impact quote turnaround time and chair build time. Pricing for these custom options may vary based on the amount of added labor and material costs.

# Hybrid seat pan/tension-adj-by-strap seat upholstery CMD #13

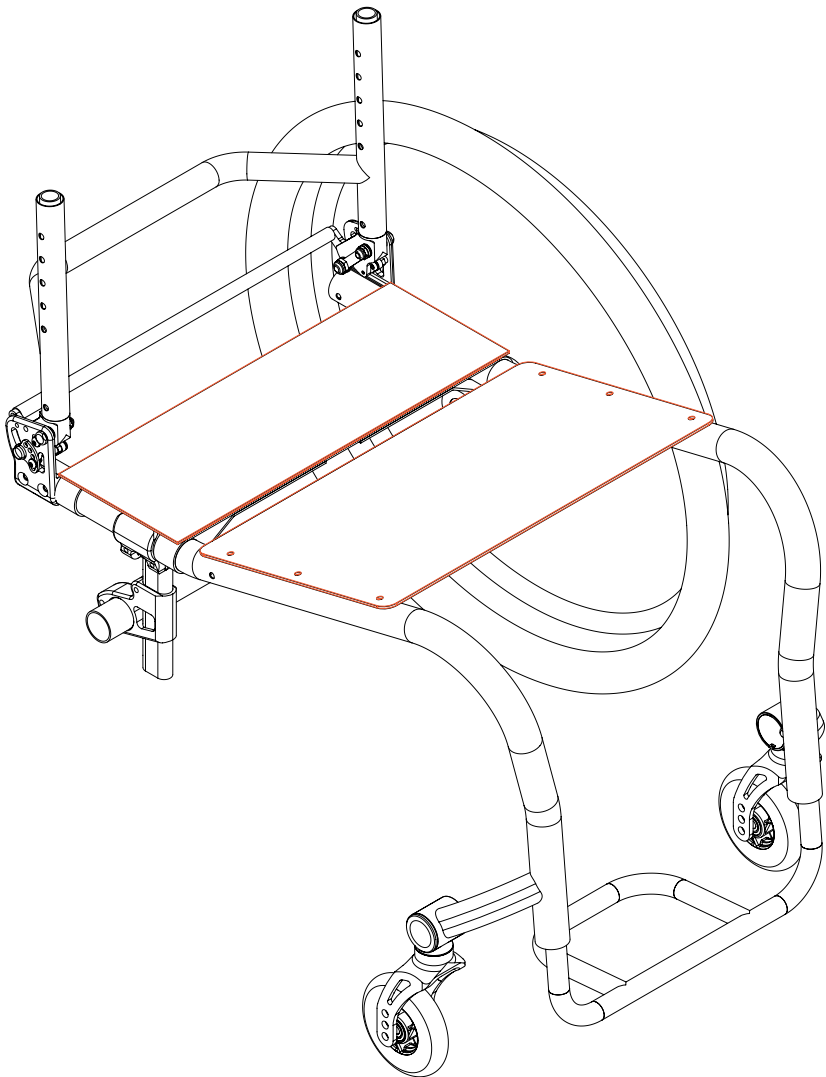

EZ-Ti ID \_\_\_\_\_  
PO# \_\_\_\_\_

**Clinical rationale**

This modification is indicated for people who require a solid seat pan on the distal end of the seat to improve support for transfers or for unique lower extremity positioning. Specific applications can be paired with ergonomic seat or to address the needs of lower extremity propellers.

**Available on:**

TiLite TR, TiLite TRA, TiLite ZR, TiLite ZRA, TiLite Aero T, TiLite Aero Z

**Notes:**

- Only available for rigid frames but will include non-tapered, tapered, and ergo frames.
- Seat pan may be placed on rear or front section of seat upholstery.
- The upholstery section of the seat will be tension adjustable by strap.
- May not work with all chair configurations.

**Required information**

(Insert required information for CMD-E to complete this request)

Seat pan location: ☐ Front OR ☐ Rear

Special Instructions



⚠ NOTE: Permobil's warranty does not cover Creative Mobility Division frames and frame components, unless Permobil determines that the frame or frame component was defectively manufactured.

# Ergo-split seat pan

## CMD #16

EZ-Ti ID \_\_\_\_\_

PO# \_\_\_\_\_

### Clinical rationale

This modification is indicated for individuals who have an ergonomic seat and require a solid seat pan for posture and positioning.

### Available on:

TiLite TR, TiLite TRA, TiLite Aero T, TiLite ZR, TiLite ZRA, TiLite Aero Z

### Notes:

- Only available for ergonomic frames.
- Seat Pan size is dependent on Ergo Seat dimension and will be built based off seat depth.
- May not work with all chair configurations.

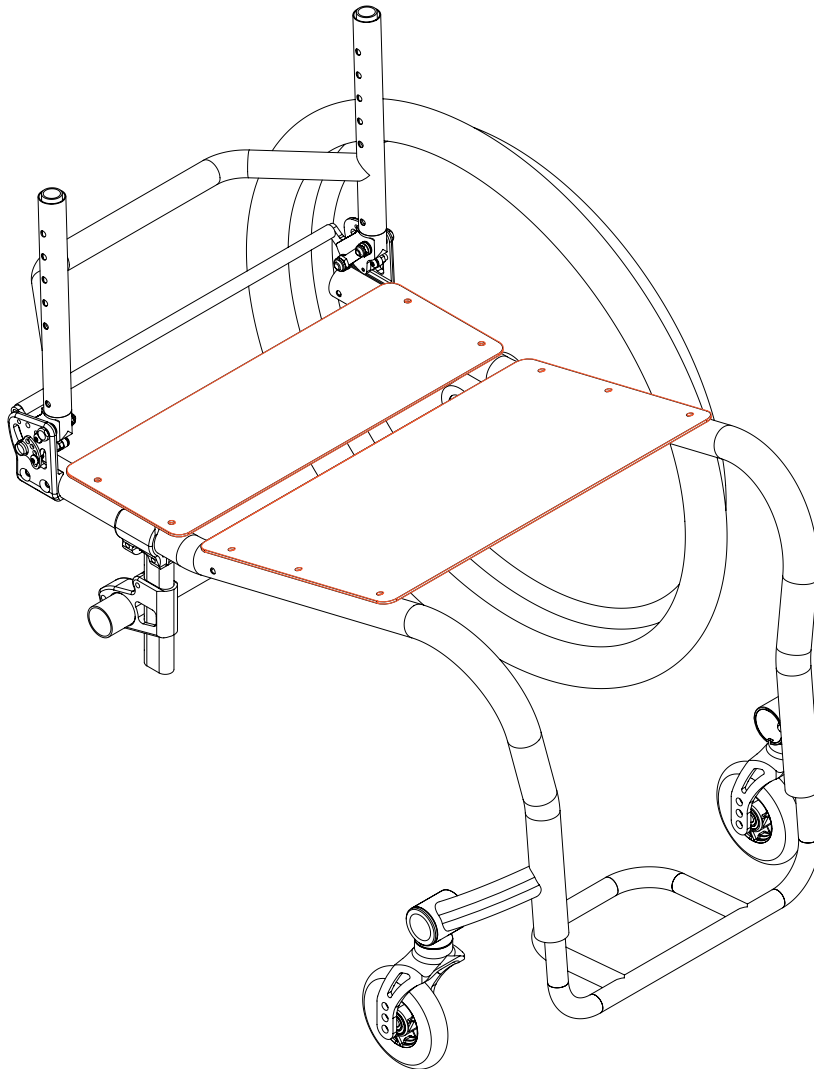

### Special Instructions

**permobil**

⚠ NOTE: Permobil's warranty does not cover Creative Mobility Division frames and frame components, unless Permobil determines that the frame or frame component was defectively manufactured.

# iSleeve

## CMD #18

EZ-Ti ID \_\_\_\_\_

PO# \_\_\_\_\_

**Clinical rationale**

Modification is indicated for individuals who have a cellphone and require a place to safely store it while in their manual wheelchair. Sleeve can be sewn to accommodate size of client’s phone.

**Available on:**

TiLite TR, TiLite TRA, TiLite ZR, TiLite ZRA, TiLite Aero T, TiLite Aero Z

**Notes:**

- May not work on all chair widths or configurations.
- Limited to seat slings that are 13” wide or wider.
- The sleeve may not be centered due to seat sling and/or iSleeve size.
- The iSleeve width can be up to 9” smaller than the chair’s seat width.
- iSleeve depth can be up to 2” smaller than the seat depth of the sling.
- Some seat widths in relation to the size of the iSleeve may require the sleeve to be off center.
- Velcro closure will be sewn at opening.
- Standard iSleeve dimensions are: Width = 3.25”, Depth = 6.25”.

**Required information**

(Insert required information for CMD-E to complete this request)

If trying to fit a certain device, please add 1” to the depth and ¼” to the width of the opening iSleeve dimensions.

Width: \_\_\_\_\_

Depth: \_\_\_\_\_

Special Instructions



⚠ NOTE: Permobil's warranty does not cover Creative Mobility Division frames and frame components, unless Permobil determines that the frame or frame component was defectively manufactured.

# Bolt on seat sling: Ergo or tapered/ abducted seats CMD #20

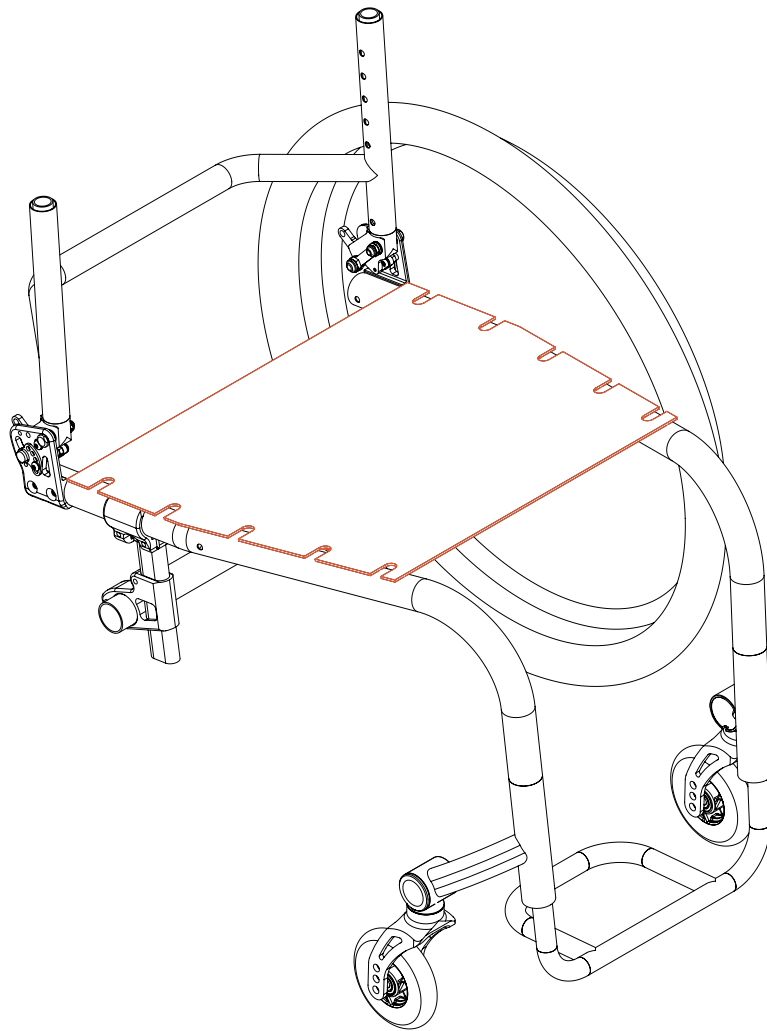

EZ-Ti ID \_\_\_\_\_

PO# \_\_\_\_\_

## Clinical rationale

Modification is indicated for individuals who require the support provided by the bolt on seat sling, or someone who may be unable to tolerate the tension adjustable by strap seat.

## Available on:

TiLite TR, TiLite TRA, TiLite ZR, TiLite ZRA, TiLite Aero T, TiLite Aero Z

## Notes:

- Only available on Rigid Frames.
- May not work with all chair configurations.

## Special Instructions



⚠ NOTE: Permobil's warranty does not cover Creative Mobility Division frames and frame components, unless Permobil determines that the frame or frame component was defectively manufactured.

# Removable seat pan CMD #38

EZ-Ti ID \_\_\_\_\_

PO# \_\_\_\_\_

## Clinical rationale

This modification is indicated for individuals who have a folding frame chair but require the rigidity and support of a solid seat pan.

## Available on:

TiLite Aero X, TiLite 2GX, TiLite TX1

## Notes:

- Only available on folding wheelchairs.
- No more than +1 frame depth.
- This is an imperial-hardware assembly.
- May not work with all chair configurations.
- Pan will be made to cross tube dimensions called out on order unless otherwise stated.

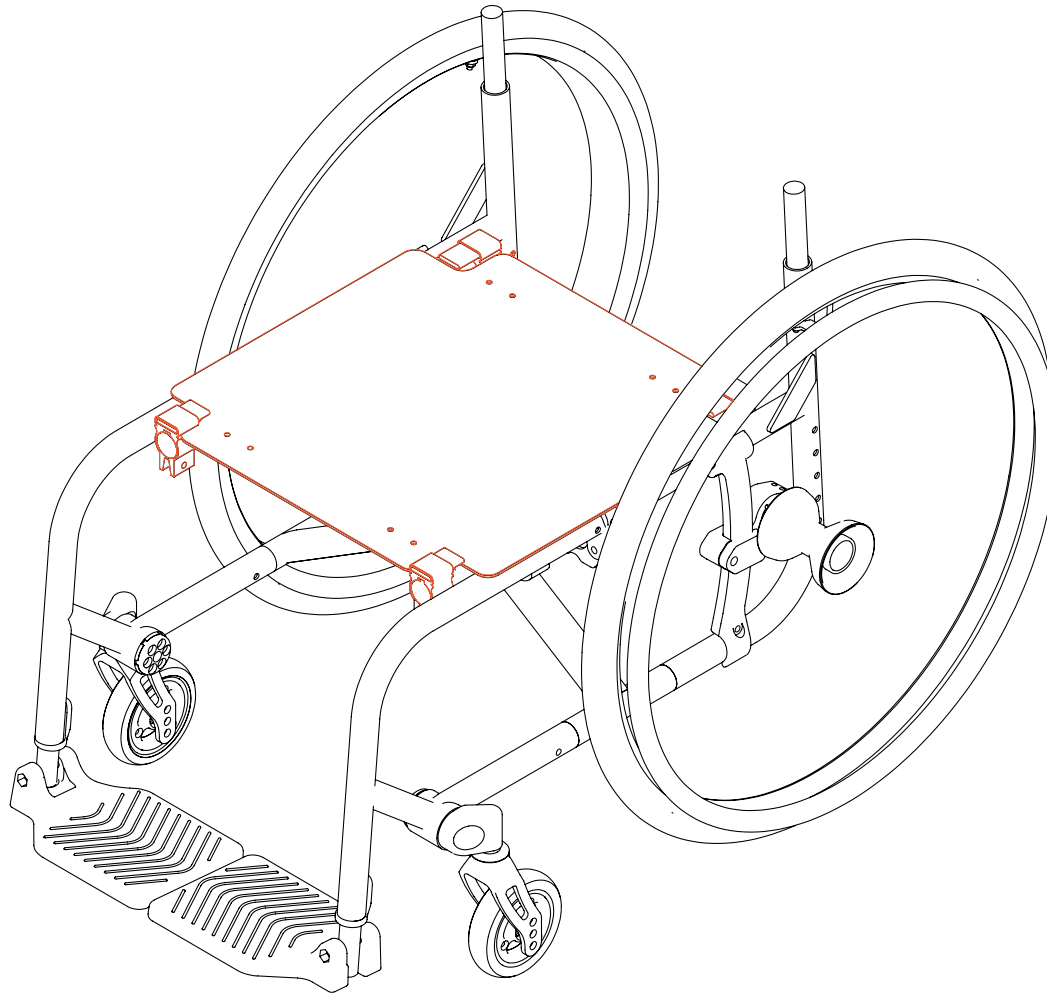

## Special Instructions

**permobil**

⚠ NOTE: Permobil's warranty does not cover Creative Mobility Division frames and frame components, unless Permobil determines that the frame or frame component was defectively manufactured.

# Adapted upholstery

## CMD #68

EZ-Ti ID \_\_\_\_\_

PO# \_\_\_\_\_

**Clinical rationale**

Modification indicated to achieve integration of upholstery with non-standard frame configurations or meet the needs of specific seating components to be installed.

**Available on:**

TiLite TR, TiLite TRA, TiLite ZR, TiLite ZRA, TiLite Aero T, TiLite Aero Z, TiLite Aero X, TiLite 2GX, TiLite TWIST

**Notes:**

- Use space below to sketch or design desired upholstery.
- Some requests will not be achievable.



### Special Instructions



⚠ NOTE: Permobil's warranty does not cover Creative Mobility Division frames and frame components, unless Permobil determines that the frame or frame component was defectively manufactured.



# TWIST solid seat pan or insert

## CMD #78

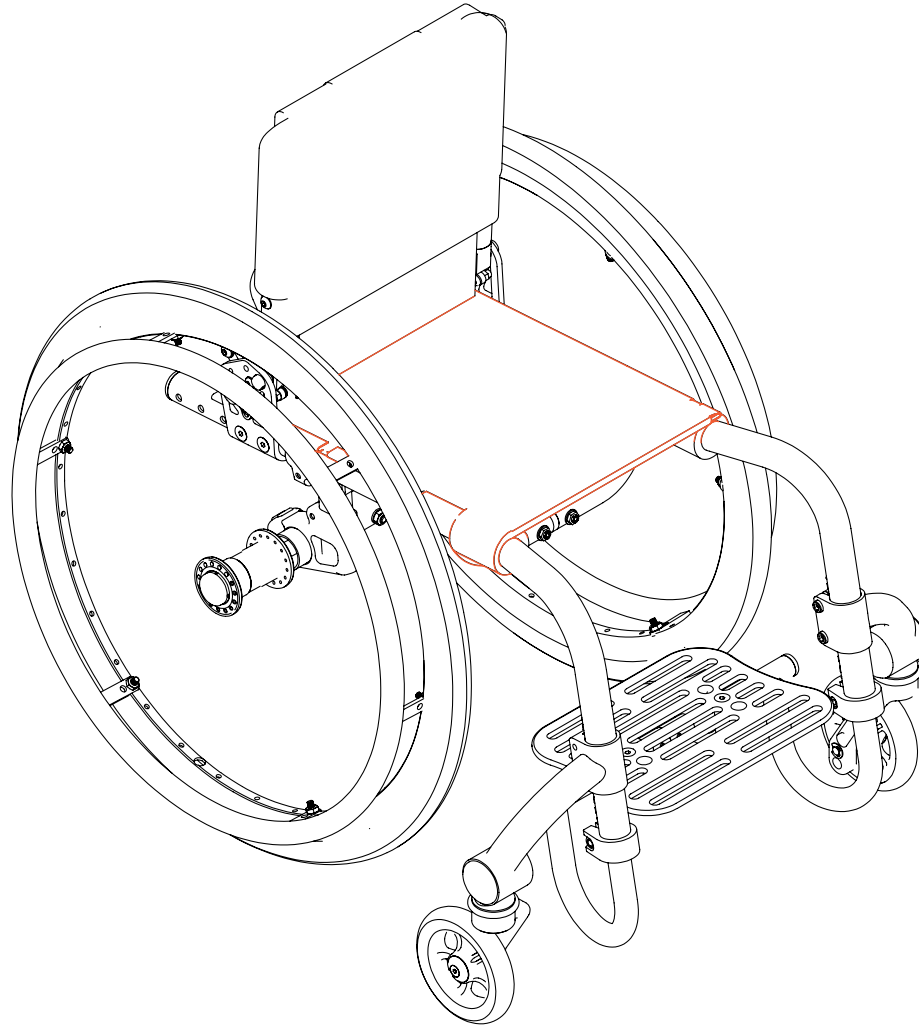

EZ-Ti ID \_\_\_\_\_

PO# \_\_\_\_\_

### Clinical rationale

Indicated to provide a stable platform for pelvis through a consistently solid surface, impacting overall postural alignment and stability during propulsion and functional activities.

### Available on:

TiLite TWIST and extra large rigid wheelchair models.

### Notes:

For the rigid wheelchair:

- Models that are 21-22" width and/or depth, the seat pan will be made from .190" thick aluminum and will be sewn into a seat sling. It will be bolted to the seat tube.

For the TWIST, available as:

- A seat upholstery insert.
- A direct bolt-on solid seat pan onto frame.
- A blank pan to be drilled/installed by dealer.
- May not work with all chair configurations.

### Required information

(Insert required information for CMD-E to complete this request)

☐ Bolt on (this will be our default if no other choice is selected below)

OR

☐ Sewn into tension adjustable by strap seat sling (Note that a new seat sling with pan insert will need to be ordered each time the seat depth is changed)

OR

☐ Powder-coated, non-drill, seat pan with trim (unless sewn into upholstery).

### Special Instructions

**permobil**

⚠ NOTE: Permobil's warranty does not cover Creative Mobility Division frames and frame components, unless Permobil determines that the frame or frame component was defectively manufactured.

TiLite manual wheelchairs

# Creative Mobility Division

2701 West Court St, Pasco, WA 99301  
Phone +1 509 586 6117 | 800 545 2266



permobil