

TiLite manual wheelchairs | Creative Mobility Division

# Push handle options



# How to order

## Catalog

1. Identify CMDs you wish to order and fill out. Please confirm compatibility with the chair you're ordering.
2. Fill out the catalog page corresponding to that CMD with the required information for us to complete your request.
  - EZ-Ti ID, PO#, or Quote# if available.
  - Measurements, selections, and special instructions if necessary.
3. Email the filled out page(s) to [chairs.tilite@permobil.com](mailto:chairs.tilite@permobil.com) and include Order Form if applicable.

## Order Forms

1. Identify CMDs you wish to order and fill out. Please confirm compatibility with the chair you're ordering.
2. In the "Notes" section on the last page of the order form, include the following information:
  - CMD number(s) being requested.
  - Measurements, selections, and special instructions if necessary.
3. Submit Order Form via email ([chairs.tilite@permobil.com](mailto:chairs.tilite@permobil.com)) or fax (509) 586-2413.

## EZ-Ti

1. Identify CMDs you wish to order and fill out. Please confirm compatibility with the chair you're ordering.
2. In the "CMD" section on the Summary page of EZ-Ti, include the following information:
  - CMD number(s) being requested.
  - Measurements, selections, and special instructions if necessary.
3. Submit quote request via EZ-Ti.

Please note, custom requests may impact quote turnaround time and chair build time. Pricing for these custom options may vary based on the amount of added labor and material costs.

# Unique size integrated push handles

## CMD #23

EZ-Ti ID \_\_\_\_\_

PO# \_\_\_\_\_

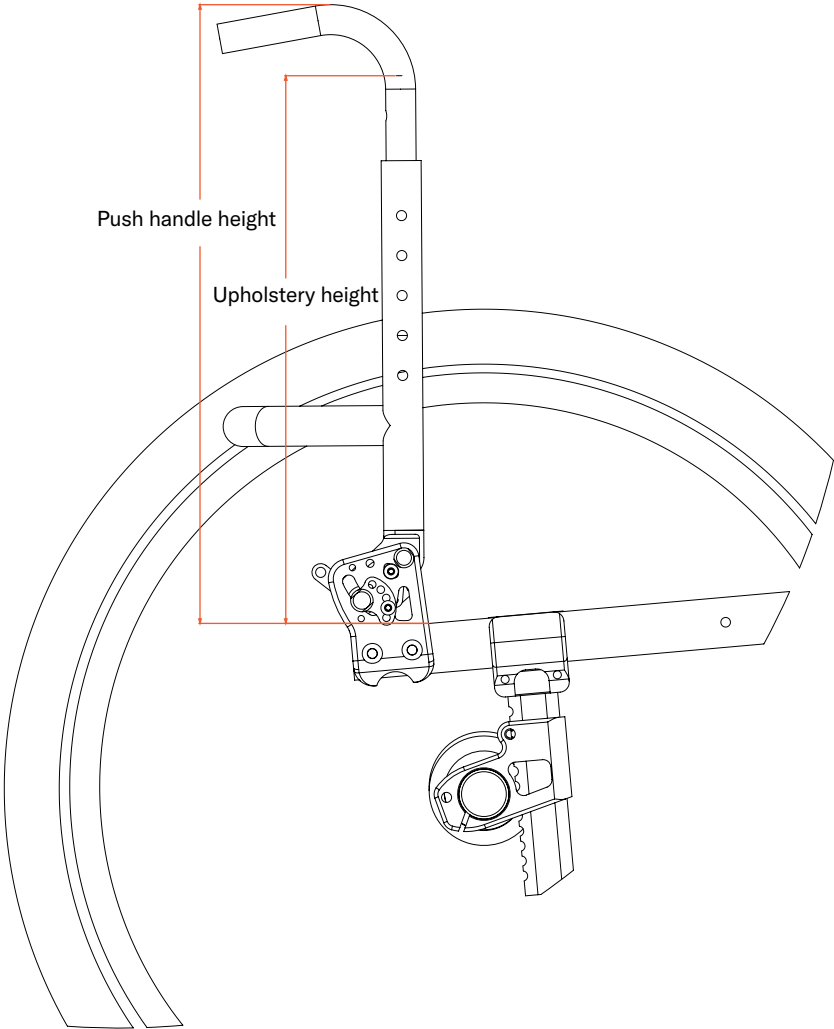

**Clinical rationale**

Modification is indicated for individuals who require the push handles 2.25" above the height of the upholstery. Indication may allow client to hook arm around push handles or may give caregiver the ability to easily push the chair when assistance is needed.

**Available on:**

TiLite TR, TiLite TRA, TiLite ZR, TiLite ZRA, TiLite Aero T, TiLite Aero Z, TiLite Aero X, TiLite 2GX

**Notes:**

- May not work with all chair configurations.
- Max height is 4" over highest standard setting.

**Required information**

(Insert required information for CMD-E to complete this request)

Push-handle Height (from seat):\_\_\_\_\_

Upholstery Height (from seat):\_\_\_\_\_

Special Instructions



⚠ NOTE: Permobility's warranty does not cover Creative Mobility Division frames and frame components, unless Permobility determines that the frame or frame component was defectively manufactured.

# Center mount push handle

## CMD #44

EZ-Ti ID \_\_\_\_\_

PO# \_\_\_\_\_

### Clinical rationale

Modification indicated for individuals whose chair cannot accommodate dual push handles or to allow caregiver to walk alongside wheelchair while being pushed.

### Available on:

TiLite TR, TiLite TRA, TiLite Aero T, TiLite ZR, TiLite ZRA, TiLite Aero Z

### Notes:

- Only available on rigid chairs.
- Backrest rigidizer bar will be bent, not rounded.
- Backrest will be made from aluminum only.
- 165 lbs. weight limit.
- 15" wide chair is maximum.
- Push handle is height adjustable.
- May not work with all chair configurations.
- Max height is 4" over standard for push handle.
- If a parts order, a TWIST Backrest is required.

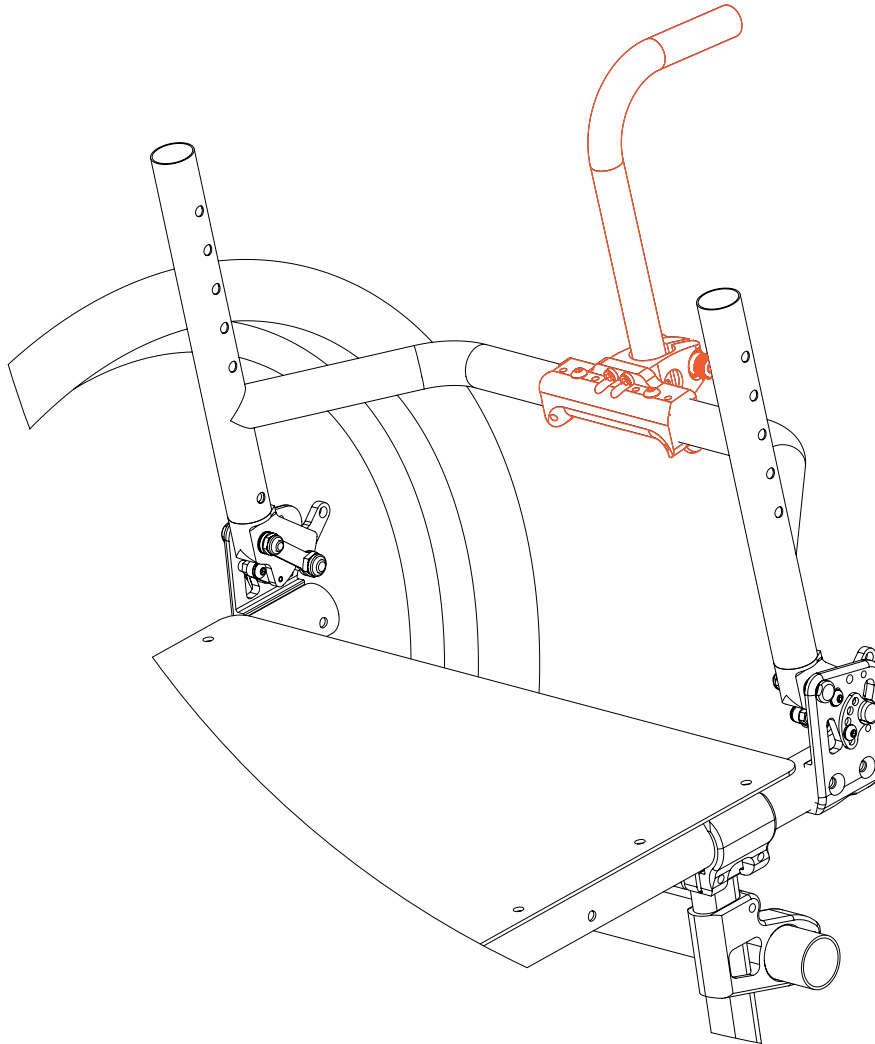

### Special Instructions



⚠ NOTE: Permobil's warranty does not cover Creative Mobility Division frames and frame components, unless Permobil determines that the frame or frame component was defectively manufactured.

# Fixed height back with 1" diameter push handles

## CMD #31

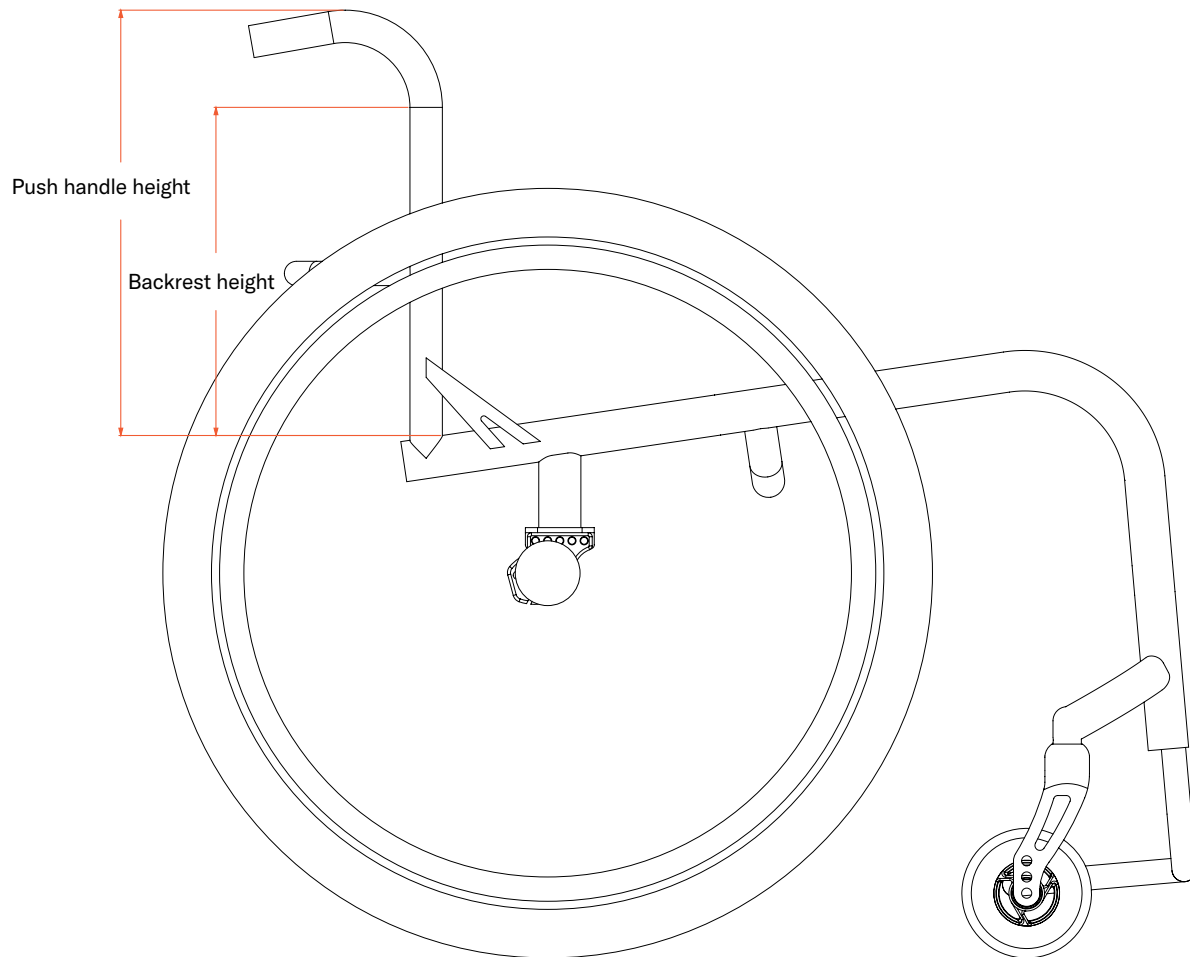

EZ-Ti ID \_\_\_\_\_

PO# \_\_\_\_\_

### Clinical rationale

Modification indicated for individuals who have a fixed/non-folding backrest but also require push handles for propulsion assistance or for hooking.

### Available on:

TiLite TR, TiLite TRA, TiLite ZR, TiLite ZRA, TiLite Aero T, TiLite Aero

### Notes:

- Must be a fixed seat back height.
- Must be a titanium backrest.
- Option not available with Transit Tie-Down Option or Wheelchair Transport Bracket Option.
- Backrest Height cannot exceed 18".
- May not work with all chair configurations.
- Max push handle height is limited to 4" over standard.

### Required information

(Insert required information for CMD-E to complete this request)

☐ Non-folding backrest (only available on titanium model wheelchairs)

OR

☐ Folding backrest

### Special Instructions

**permobil**

⚠ NOTE: Permobil's warranty does not cover Creative Mobility Division frames and frame components, unless Permobil determines that the frame or frame component was defectively manufactured.

# Non-adjustable adapted height bolt-on push handles CMD #63

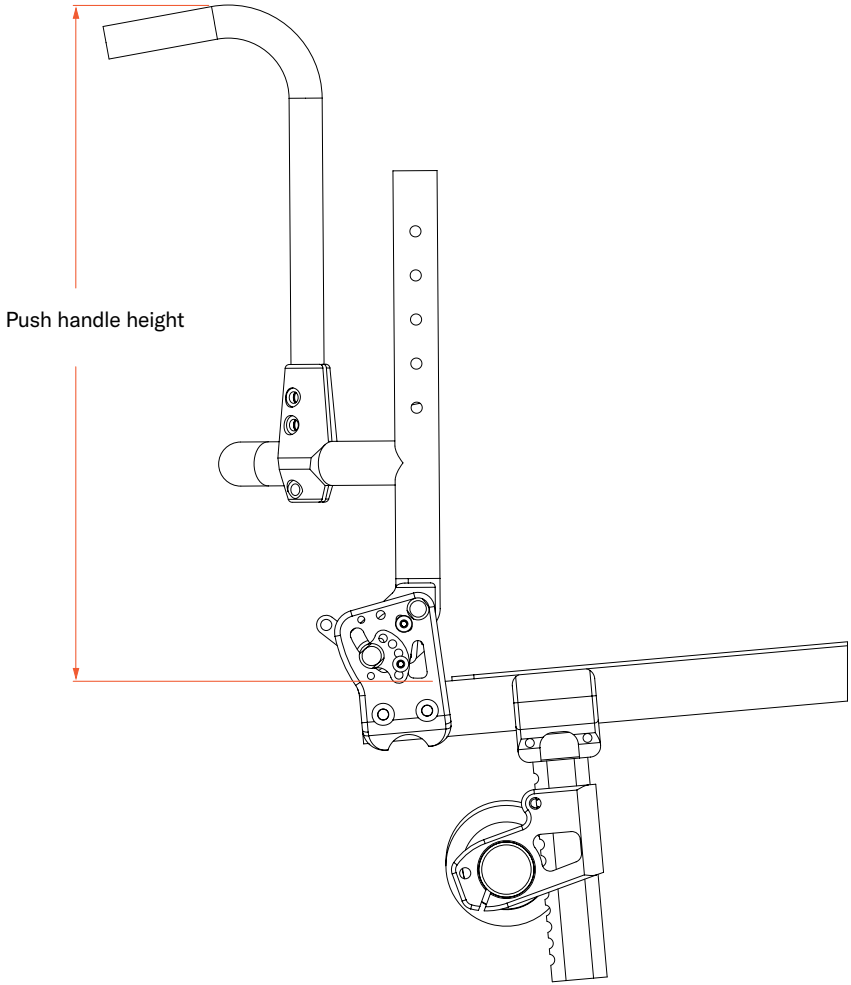

EZ-Ti ID \_\_\_\_\_

PO# \_\_\_\_\_

**Clinical rationale**

Modification indicated for customized bolt-on push handle height to achieve improved access to push handles independent of rear seat-to-floor height configuration or limit functional interference.

**Available on:**

TiLite TR, TiLite TRA, TiLite ZR, TiLite ZRA, TiLite Aero Z, TiLite Aero T

**Notes:**

- May not work on all configurations.
- We are limited to these push handles being 4” taller than our tallest standard height push handle.
- Chair requires a backrest with a bent (non-rounded) backrest rigidizer bar.
- Chairs with aluminum backrests that are 16” wide or wider, require HD Aluminum backrests.
- May not work with all chair configurations.

**Required information**

(Insert required information for CMD-E to complete this request)

Height: \_\_\_\_\_

## Special Instructions



⚠ NOTE: Permobil's warranty does not cover Creative Mobility Division frames and frame components, unless Permobil determines that the frame or frame component was defectively manufactured.

# Adapted adjustable height push handles

## CMD #64

EZ-Ti ID \_\_\_\_\_

PO# \_\_\_\_\_

**Clinical rationale**

Modification indicated for customized push handle height to achieve improved access to push handles and/or limit functional interference.

**Available on:**

TiLite TR, TiLite TRA, TiLite ZR, TiLite ZRA, TiLite Aero Z, TiLite Aero T, TiLite TWIST

**Notes:**

- May not work on all configurations.
- We are limited to these push handles being 4” taller than our tallest standard height push handle.
- Chair requires a backrest with a bent (non-rounded) backrest rigidizer bar.
- Chairs with aluminum backrests that are 16” wide or wider, require HD Aluminum backrests.
- May not work with all chair configurations.

**Required information**

(Insert required information for CMD-E to complete this request)

Height to seat: \_\_\_\_\_

Range desired: \_\_\_\_\_

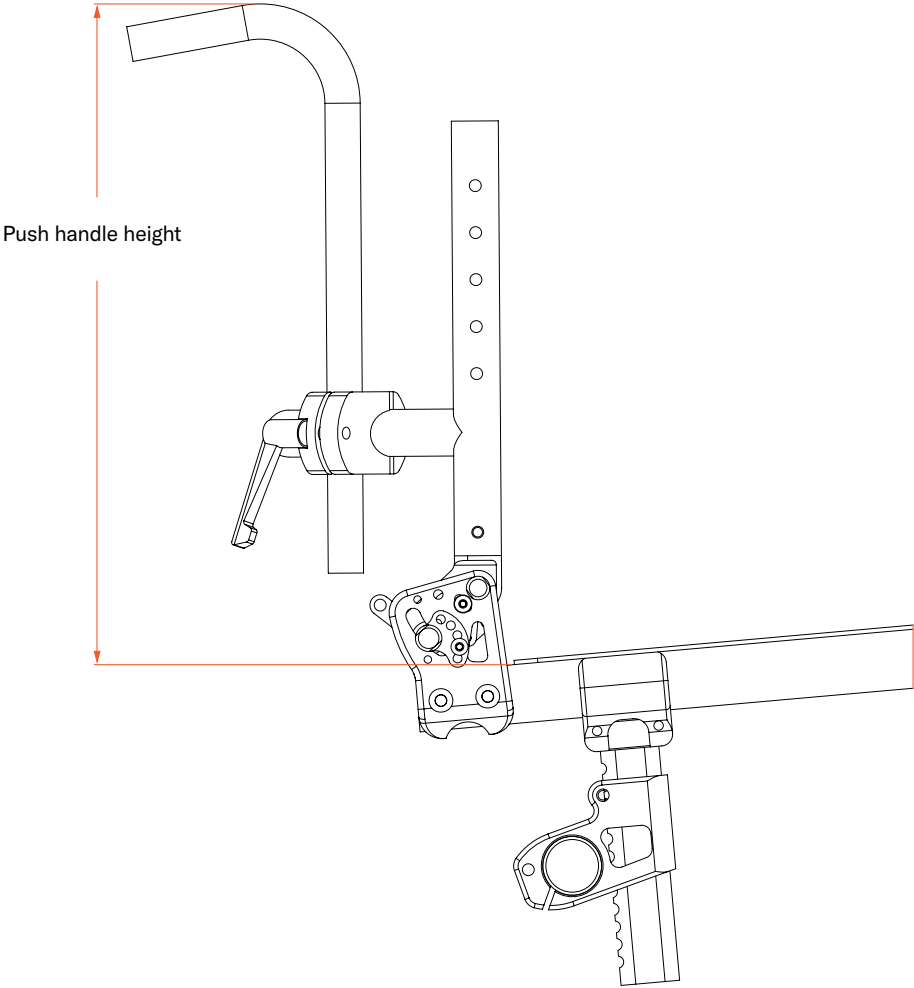

### Special Instructions



⚠ NOTE: Permobil's warranty does not cover Creative Mobility Division frames and frame components, unless Permobil determines that the frame or frame component was defectively manufactured.

TiLite manual wheelchairs

# Creative Mobility Division

2701 West Court St, Pasco, WA 99301  
Phone +1 509 586 6117 | 800 545 2266



permobil