

Smart Check Smart Setup Instructions

Smart Check will find and save the inflation setting for you, on your cushion, in your chair. **NOTE:** Results may vary based on body type.



- Perform the following steps in the usual environmental conditions.
- The cushion **MUST** be overinflated to start Smart Setup. You may temporarily feel unstable; if so, proceed with caution.
- The individual **MUST** be seated on the cushion in the chair before using Smart Check.

Symbols and Lights for Smart Setup

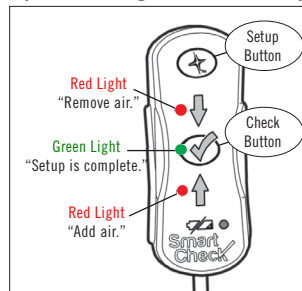

1. Place the cushion in the chair. Place the nozzle of the pump over the inflation valve.

If a cushion cover is used, place the cover on the cushion before inflating.

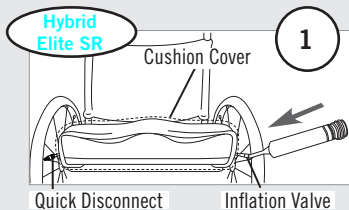
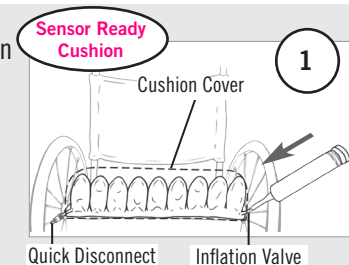

2. Open the inflation valve. Overinflate the cushion until it bulges. Close the inflation valve. Remove the pump.

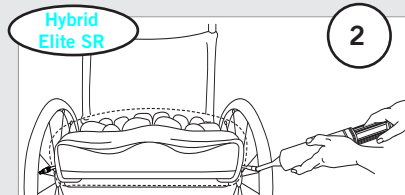

3

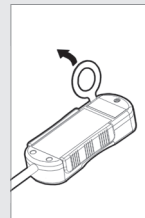

3. Sit in the chair in your usual position. Pull to remove the tab (*first-time use only*).

4

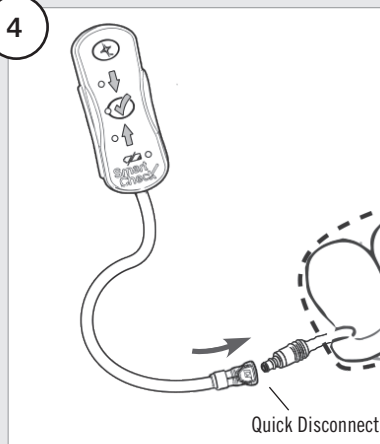

4. Make sure the inflation valve is closed. Attach Smart Check to the cushion. You will hear a “click” when the connection is secure.



Smart Setup Instructions, Continued

5a.

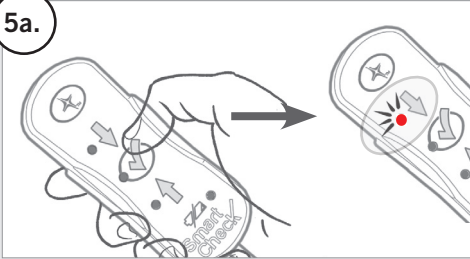

5a. Press the Check ✓ Button.
When you see the red down arrow ↓ light,
proceed to step 5b.

NOTE: If you see the red up arrow ↑ light when you press the Check Button:
1) Make sure the quick disconnect is securely attached, and 2) Open the inflation valve, add more air, close the inflation valve, and press the Check ✓ Button again. *Repeat until you see the red down arrow light.*

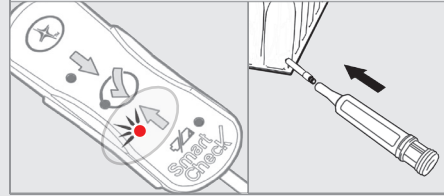

5b.

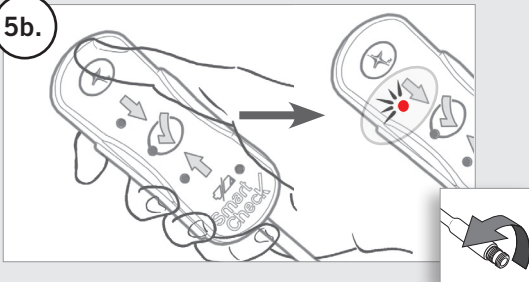

5b. Press (but do not hold) the Setup Button.
The red down arrow ↓ light will now **flash**.
Open the inflation valve, release air (approximately 30
to 60 seconds)*, and wait for the flashing green light.

If the red down arrow ↓ light stops flashing before you
have opened the valve, go back to 5a.

***To ensure an accurate reading:** Remain still and avoid
restricting air flow while you release air from the cushion.

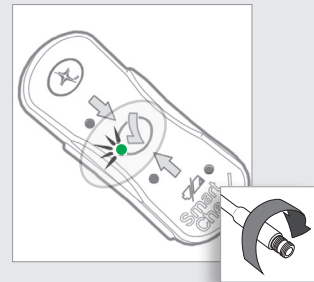
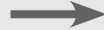

When you see the flashing green
light, close the inflation valve. The
green light means that Setup is
complete.

Your cushion is now set up.
(Next: See CHECK INSTRUCTIONS.)



Store Smart Check in a safe and accessible location. See DISCONNECTION AND STORAGE instructions.